

# HELLER

Instruction Manual

## High Velocity Tower Fan with Remote Control

Model: HVTF4R



READ AND SAVE THESE INSTRUCTIONS

Please read and follow the instructions in this user manual even if you feel you are familiar with the product, and find a place to keep it handy for future reference.

For your convenience record the complete model number (located on the product identification plate) and the date you received the product, together with your purchase receipt and attach to the warranty and service information. Retain in the event that warranty service is required.

NOTE: The rating of this product (as marked on the product identification plate) is based on specific loading tests. Normal use or the use of other recommended attachments may draw significantly less power.

## Important Safeguards

**When using any electrically powered product, basic safety precautions should always be followed, including the following:**

PLEASE READ ALL INSTRUCTIONS CAREFULLY BEFORE USING THIS PRODUCT

WARNING!: - to reduce the risk of fire, electrical shock or injury to persons or property:

- Always operate the product from a power source of the same voltage, frequency and rating as indicated on the product identification plate.
- Remove the unit from its packaging and check to make sure it is in good condition before using.
- Do not let children play with parts of the packaging (such as plastic bags).
- Close supervision is necessary when the product is used by or near children or infirm persons. Do not allow children to use it as a toy.
- Do not operate any product with a damaged cord or plug, or after the product malfunctions, or is dropped or appears damaged in any way. Return the complete product to the place of purchase for inspection, repair or replacement.
- Before unplugging the power cord, be sure to turn the power off. When touching the unit, be sure your hands are dry to prevent electrical shock.
- Avoid making contact with moving parts. Never insert fingers, pencils or any other objects through the guards whenever the power plug is connected, especially while the unit is working.
- Always place the fan on a stable, level surface when operating to prevent the fan from overturning. Do not run the power cord under carpet. Do not cover the power cord with throw rugs or runners. Route the power cord away from walking paths so that nobody can trip over it. The cable should be kept away from heat, sharp edges and oil.
- Your fan should be placed away from heat sources such as; radiators, gas/electric heaters and direct sunlight.
- To reduce the risk of electric shock, do not immerse or expose the product or flexible cord to rain, moisture or any liquid other than those necessary for correct operation of the product.
- This product should not be used in the immediate vicinity of water, such as bathtub, washbowl, bathroom swimming pool etc. Where the likelihood of immersion or splashing could occur.
- Switch off and unplug from outlet when not in use, before assembling or disassembling parts and before cleaning. Remove by grasping the plug - do not pull on the cord.
- Be sure that no other high current appliances are plugged into the same circuit as your fan, as an overload can occur.
- Do not remove any fixed covers.
- Avoid the use of an extension cord as the extension cord may overheat and cause a risk of fire.
- Do not use the appliance for other than its intended use.
- Do not use outdoors. **FOR INDOOR USE ONLY.**
- Do not leave the appliance unattended when switched on.
- Do not use the Fan without the support bases fitted to the unit.

- Do not cover the grill, or operate in close proximity to curtains etc.
- The use of attachments or accessories not recommended or sold by the product distributor may cause personal or property hazards or injuries.
- This product is intended for normal domestic/household use only.
- Use this fan as described in this manual. Any other uses, not recommended by the manufacturer, may cause fire, electric shock, or injury to persons and may void the warranty.
- This appliance is not intended for use by persons (including children) with reduced physical, sensory or mental capabilities, or lack of experience and knowledge, unless they have been given supervision or instruction concerning the use of the appliance by a person responsible for their safety.
- The installation of a residual current device (safety switch) is recommended to provide additional safety protection when using electrical appliances. It is advisable that a safety switch with a rated residual operating current not exceeding 30mA be installed in the electrical circuit supplying the appliance. See your electrician for professional advice.

## Parts Location

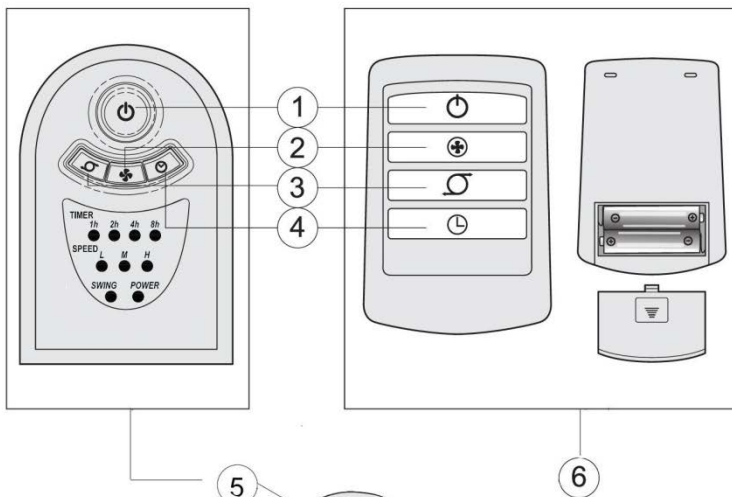

1. On/Off button
2. Air power/speed button
3. Oscillation button
4. Timer button
5. Control panel
6. Remote control
7. Display lens
8. Place for remote
9. Remote control keeping
10. Louvers
11. Air outlet grating
12. Fan case
13. Power cord hook
14. Air inlet grating
15. Power cord
16. Support

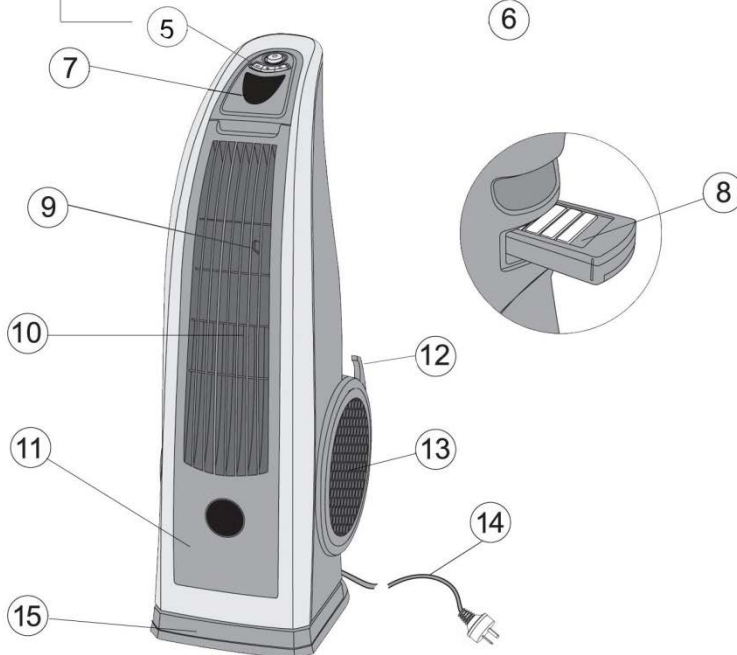

## Before First Use

Before use, remove all packaging and inspect the appliance for any damage. If there appears to be any damage, please take the unit back to place of purchase for a replacement.

## Operating Instructions

*Before inserting the plug into a power outlet, make sure that the correct voltage being used corresponds to what is indicated on the rating label, and that the socket has an earth facility.*

1. Place your fan on a firm, level surface away from moisture and heat sources.
2. Connect to power outlet and turn the power supply on.  
***You may control your fan either with the remote control or with the buttons on the control panel.***
3. Press the ON/OFF button (1) the indicator light on this button will turn on and a sound signal will be heard. The ventilator will start operating.
4. Select the desired speed by pressing the air power/speed button (2). The indicator light on the button will show the power chosen:
  - L - LOW
  - M - MEDIUM
  - H- HIGH
5. To start the oscillating function, press the oscillation button (3). To stop the unit from oscillating press the button again.
6. To set the sleep timer, press the timer button (4), the indicator light on the button will show the set time. You can set the timer in 0.5 or 4 hour sequences, with a maximum of 8 hours.
7. Press the ON/OFF button to turn the unit 'Off'.

### Remote control operation:

1. Open the battery compartment lid of the remote control and insert 2 AAA batteries.
2. Close the battery compartment lid.

**The functions of the remote control fully correspond to that of the control panel.**

You can conveniently store the remote control in the appliance (8).

## Care & Cleaning

1. Switch off and unplug the power supply before cleaning.
2. Clean the surface of the unit with a soft dry cloth.
3. Do not use solvents or abrasive cleaners on this appliance.
4. Do not immerse the fan in water or any other liquid. In order to avoid electric shock, take care that no water enters the fan.
5. To clean the air inlets you can use a vacuum cleaner with a corresponding attachment.

## Specifications

Model	Description	Voltage	Frequency	Wattage
HVTF4R	High Velocity Tower Fan with Remote Control	230-240V~	50Hz	120W

## Australian Customer Service

GAF Control (Sales) Pty Ltd

P.O Box 19

Altona North Victoria 3025

Phone: 1300 659 489

Hours: 9am-5pm (EST) Mon-Fri

[www.gafcontrol.com.au](http://www.gafcontrol.com.au)

\*This product may vary slightly to the product illustrated due to ongoing product development.