



3 IN 1 BATHROOM HEATER LIGHT

HEATER, EXHAUST FAN AND LIGHT

4 heat light / duct style exhaust fan

Thank you for selecting HELLER LED 3 in 1 bathroom heater.

Please read all instructions before commencing installation.

IMPORTANT: HELLER bathroom heater light must be installed to comply with the appropriate council regulations and the Australian and New Zealand wiring rules AS/NZS 3000:2000 or latest edition thereof.

A Licensed Electrician is required to connect this unit to the mains supply.

The mains supply and interconnecting cables required for installation of this appliance are not included, suitable cabling no lighter than ordinary duty cable rated at a minimum 10 Ampere load rating is to be used when installing / wiring the appliance.

WARNING

1. Use this heater only as described in this manual. Any other use not recommended by the manufacturer may cause fire, electric shock, or injury to persons. If you have questions, please contact the manufacturer or the local agent.
2. All wiring must be carried out by a licensed electrician in accordance with all applicable National / local codes and standards. Also check with the local council regulations regarding installation of exhaust fans.
3. Make sure the power is off before the installation.
4. When cutting into the wall, do not damage electrical wiring and other hidden utilities.
5. The heater must be properly grounded.
6. The globes are hot when in use. Do not touch the infrared globes with any part of your body when in use. Allow all globes to cool sufficiently before touching or replacement.
7. For the purpose of avoiding any dangerous gas leaking into your bathroom, the ventiduct of the heater must not be laid together with the ventiduct of air-fuelled water heater or other open-fire appliances into the same flue.
8. The heater must be isolated from power by means of a plug or all-pole disconnection switch with a contact separation of at least 3mm in each pole.

9. The power cable must stand a minimum 10 A load.
10. This appliance is not intended for use by persons (including children) with reduced physical, sensory or mental capabilities, or lack of experience and knowledge, unless they have been given supervision or instruction concerning use of the appliance by a person responsible for their safety. Children should be supervised to ensure that they do not play with the appliance.

IMPORTANT CONSIDERATIONS BEFORE INSTALLING

A few minutes planning can make a big difference to the installation time and also to your satisfaction with the function of the unit.

1. The unit should not be installed directly above shower or bathtub. The unit must not be installed in a position where water may splash onto the globes.
2. The controls must not be installed in a position accessible to a person in a bath, spa or shower.
3. The heater must not be installed beneath a fixed socket.
4. This product is designed for installation in flat ceilings only. Don't mount it on a sloping ceiling or a vertical wall.
5. The infrared globes are most effective when you are standing directly beneath them, so generally the unit would be mounted above a place where you would stand to dry yourself.
6. For the exhaust fan to work efficiently, replacement air of a volume equivalent to what is being extracted must be able to enter the room. In general, this air would be drawn under the door, or through a slightly open window. If the room is airtight, the fan will function poorly.
7. Before commencing any cutting, check in the ceiling space that there are no obstructions such as ceiling joists and that there is sufficient height clearance for the housing. Check that the electrical wiring can be routed from the wall switches to the mounting location.

INSTALLATION

1. The unit may be mounted either between joists using the inbuilt clip fasteners or against a joist using a screw through the flange plate. Use this card in its open state as a template. Place in the required location and mark out the hole cutting size. Hole size is 310mm x 300mm .

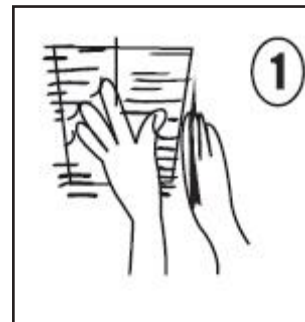

2. Before commencing cutting ensure that the area behind the intended location is clear of all cables, pipes and joists. Once clear, cut out the section along the previously marked lines.

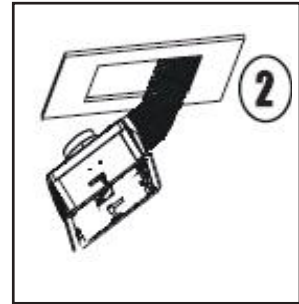

3. Remove 4 heat lamps from the bathroom heater. Unfasten the fascia retaining spring clips inside the housing, and remove the fascia. Connect the ducting if required to the outer grill of the unit. Insert the unit into the square hole being sure to pull the side springs inward so that the body can pass through the hole without damaging the plaster. Ensure that the unit is held securely in place by the clips. If required, additional screws can be used to aid holding the unit in the ceiling. Screw holes are provided in the flange for this purpose.

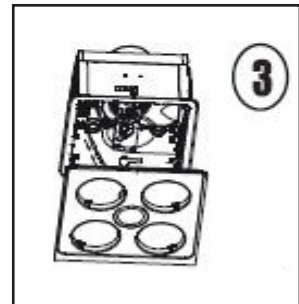

4. Hold the fascia against the body of the heater and the ceiling and attach the securing spring clips to hold the fascia in place.

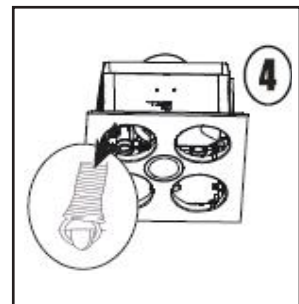

5. Now screw in the four large heat lamps into the lamp holder through the holes provided in the fascia. The globes should be screwed up firmly to ensure a good electrical contact but don't over tighten.

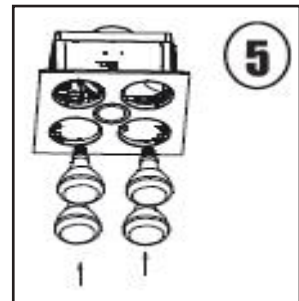

terminal block in the bathroom heater light, as per the wiring diagram below, run the neutral line to the bathroom heater unit neutral connection via the isolation switch or power outlet as used for the active line. Connect and ensure that the earth connections on the unit are properly grounded.

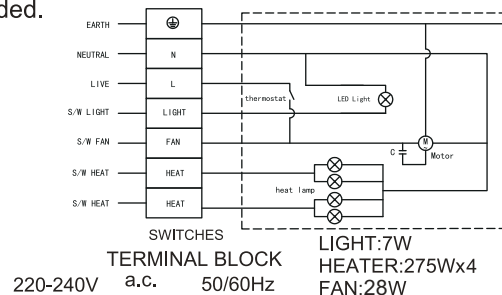

Note: the active and neutral wires must be connected via an all pole isolation switch with a 3mm contact clearance or a plug/socket.

Once the wiring is connected, replace the terminal cover on the bathroom heater light unit and locate the cabling so as to allow room for the bathroom heater light unit to be positioned into the ceiling cavity.

7. Fitting the in-house end

Fit the in-house end of the duct to the fan outlet and tighten with a duct with locking strip (not supplied).

Note: Keep the route as straight as possible.

8. Position the housing into the hole

Choose an optimal direction to put the housing into the hole in accordance with the position of fan outlet.

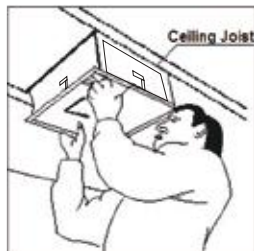

Before inserting the unit into the hole on the ceiling, pull the bar clamps into body. Then push the body of the unit into the hole, duct side first. Tighten the screws clockwise.

Ensure that the unit is held securely by the bar clamps

Note: Keep the redundant wire away from the housing.

9. Final Installation

- Replace the Fascia;

- Replace the globes;

Ensure the globes are tightened sufficiently to make good electrical contact. Clean the globes and fascia.

Fix the switch panel to the wall depending upon the location and type of material the switch is to be fitted to, a switch bracket, (not supplied), may or may not be required. Fit the switch to the wall and replace the fascia plate.

Note: The switch wiring should be routed inside the wall to give the switch an integrated built in appearance. If it is necessary to run the wiring on the outside of the wall, please use a suitable conduit and fixings to properly locate and hold the wiring used.

USE

Heller bathroom heater uses the infrared heating globes as a source of heat. It also combines the functions of exhaust and light.

Note: The heater is not intended to heat the room as the infrared action is to heat the body not the air. The heater is NOT suitable for constant use and should be switched off after approximately 1 hours use.

1. Heat

Turn On/Off “Heat” switches:

This model is supplied with two groups of infrared globes. It is recommended that you turn ON the “Fan” switch first, and then turn one or both the “Heat” switches ON to avoid the gathering of the heat.

Note: Do not touch the infrared globes with any part of your body when in use.

2. Exhaust Fan

Turn On/Off “Fan” switch:

The heater can exhaust odours and steam in a quick and efficient way by turning ON the “FAN” switch.

Note: No additional exhaust fan is necessary as the unit itself satisfies your need for exhausting in the bathroom.

3. Lighting

Turn On/Off “Light” switch.

MAINTENANCE

1. Clean

- Shut off power before cleaning.

- Ensure the globes are cooled down before handling. Wipe globes, fascia and inner part of the heater with care using a soft cloth soaked with neutral detergent. Remove dust and fuzzy dirt.

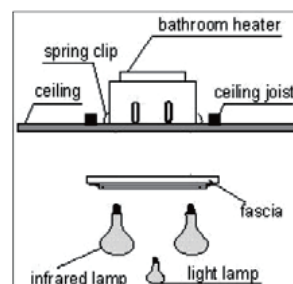

2. Globe Replacement

- Check and tighten globes regularly.

- Shut off power before replacement.

- Use 7W LED downlight for lighting.

- Use E27 275W infrared globes for heating.

Note: It may affect operation (even cause danger) when globes other than the designated ones are used.

WARRANTY

The warranty does not extend to lamp globes supplied or installation of the unit or any associated wiring or any damage caused by installation or wiring.

The installation must be conducted by a licensed electrician and a suitable certificate of safety is to be issued by the electrician who installed the unit. Warranty claims will be voided unless a certificate of safety can be produced when required, prior to service or repair.

Please keep and present the original invoice to your service agent for warranty services.

This warranty does not cover damage or loss caused by:

- Heat or light globes

- Any consequential losses arising from incorrect installation or operation or maintenance of this product.

- Any consequential losses arising from repairing of any part of this product by unauthorized persons.

- Any modification or changes made to the unit other than recommended by the manufacturer.

MAIN TECHNICAL PARAMETERS

Model Number	HEF4S HEF4W
Rated Voltage	220-240Vac
Rated Frequency	50Hz
Rated Power	1135 W
Rated Airflow	300 M ³ /Hr

LIST OF COMPONENTS SUPPLIED

Operation Unit	1 pc
Infrared Globe (E27)	4 pc
Downlight	1 pc
Instruction Card	1 pc
Ventiduct and Outdoor Vent Fascia	1 set
Duct Locking Strip	1 set
Switch	1 set

Notice: This instruction manual is also a cut out template.