



## Instruction Manual

### 40cm MISTING PEDESTAL FAN with Remote

Model: HMF40BR



**SAVE THIS BOOKLET FOR FUTURE REFERENCE**

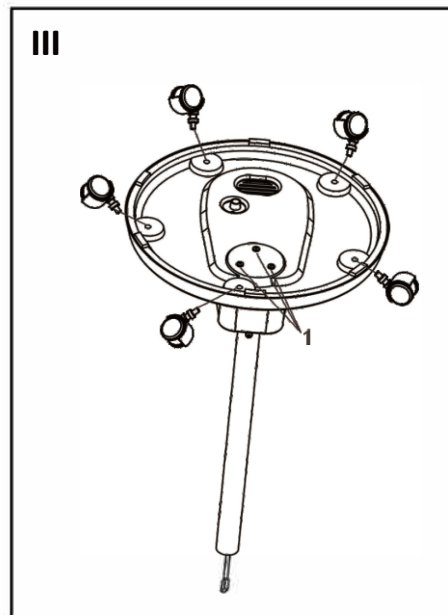
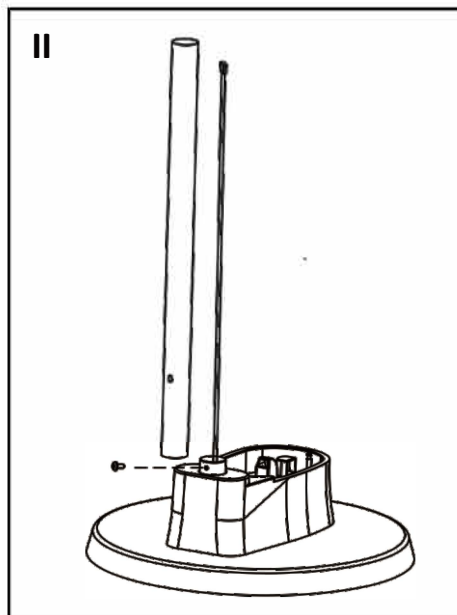
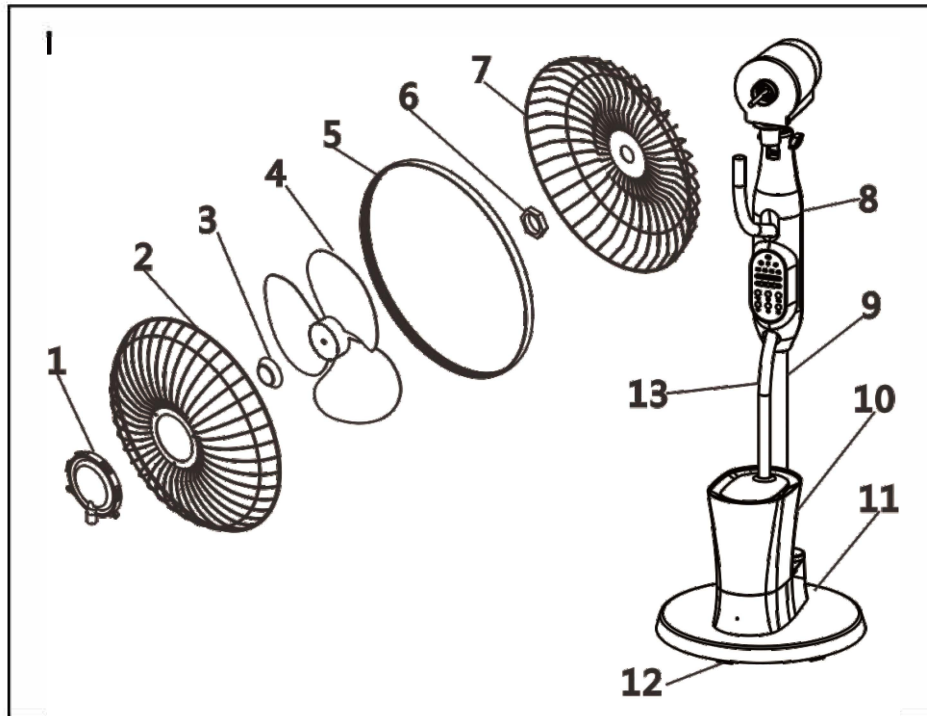

Class II symbol: this appliance is designed with double insulation. It is not necessary to connect it to earth connection.



Clean the water tank every 72 hours



The crossed-out wheeled bin symbol indicates that the item should be disposed of separately from household waste. The item should be handed in for recycling in accordance with local environmental regulations for waste disposal. By separating a marked item from household waste, you will help reduce the volume of waste sent to incinerators or land-fill and minimize any potential negative impact on human health and the environment.

#### CUSTOMER SERVICE:

Australian Customer Service  
GAF Control(Sales)Pty Ltd  
P.O.Box 19

Altona North Victoria 3025

Phone: 1300 659 489

Hours: 9am- 5pm (EST) Mon-Fri

[www.gafcontrol.com.au](http://www.gafcontrol.com.au)

\*This product may vary slightly to the product illustrated due to ongoing product development

**F: OSCILLATING BUTTON**

When you press the “OSC” button, the mist fan head will move continuously from side to side. Pressing the button again will stop the oscillation of the mist fan.

**G: REMOTE CONTROL**

The above functions can be controlled using the remote control by pressing the corresponding function buttons. See P.3, Image XII. To use the remote control, insert two AAA 1.5V batteries in the battery housing in the remote.

**CLEANING AND MAINTENANCE**

1. Always unplug the fan before cleaning it.
2. Clean the water tank and water every 72 hours to prevent the formation of scale, algae, or bacteria.
3. If you do not intend to use the fan for an extended period, empty the water tank and dry the water unit with a microfiber cloth.
4. See P.4, Image XIV, pull out the rubber stopper(1) from the drain outlet(2) to drain the water from the humidifier base.
5. If the fan will be placed in storage for a more extended period of time (over winter, etc), keep it safe and away from dust or damage.
6. To avoid damaging the plastic and indicators, do not use any abrasive cleaning agents or chemicals.
7. The fan must not be opened by unauthorized persons.

**CAUTION:** Unplug the fan from the electrical supply source before cleaning. After servicing, any safety device (including grilles and blades) it must be reinstalled or remounted as previously installed. Use a soft damp cloth then wipe with a dry cloth. Do not use harmful detergents. Do not bend the blades.

**TECHNICAL SPECIFICATIONS**

Model No.	HMF40BR
Rated Voltage(V/Hz)	220-240V~, 50-60Hz
Power Consumption	75W
Water capacity	2.8L
Water consumption	<220ml/h

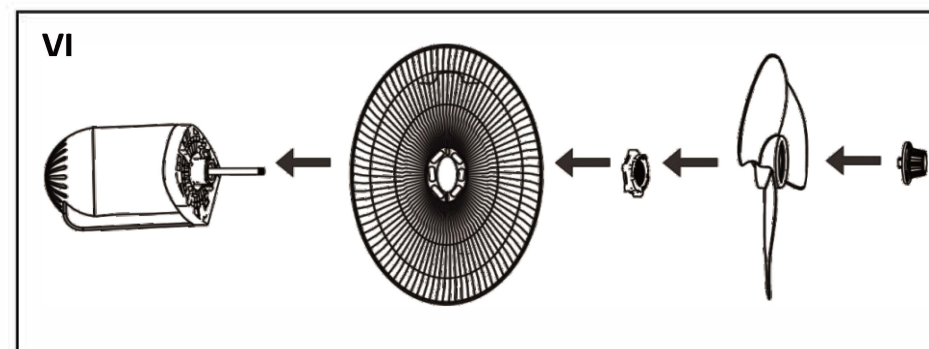
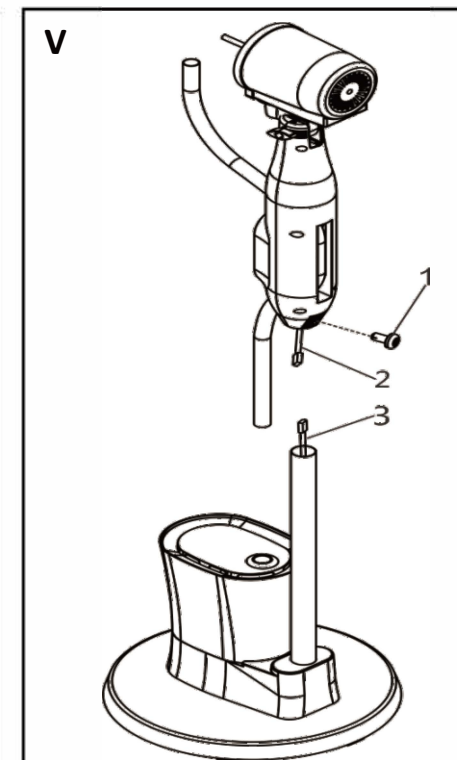
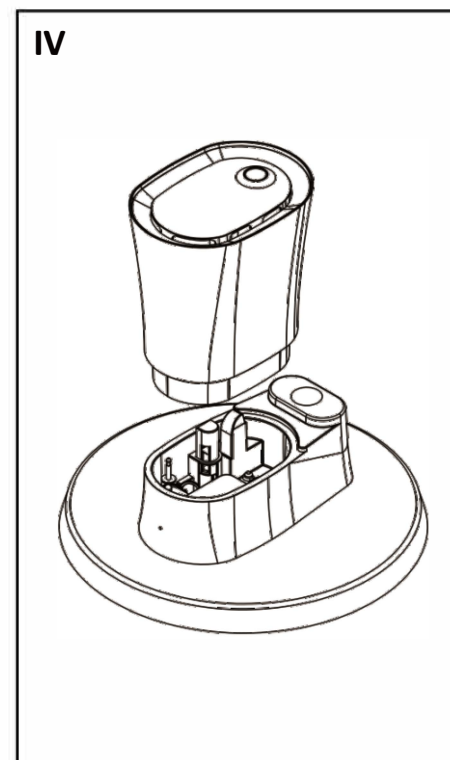

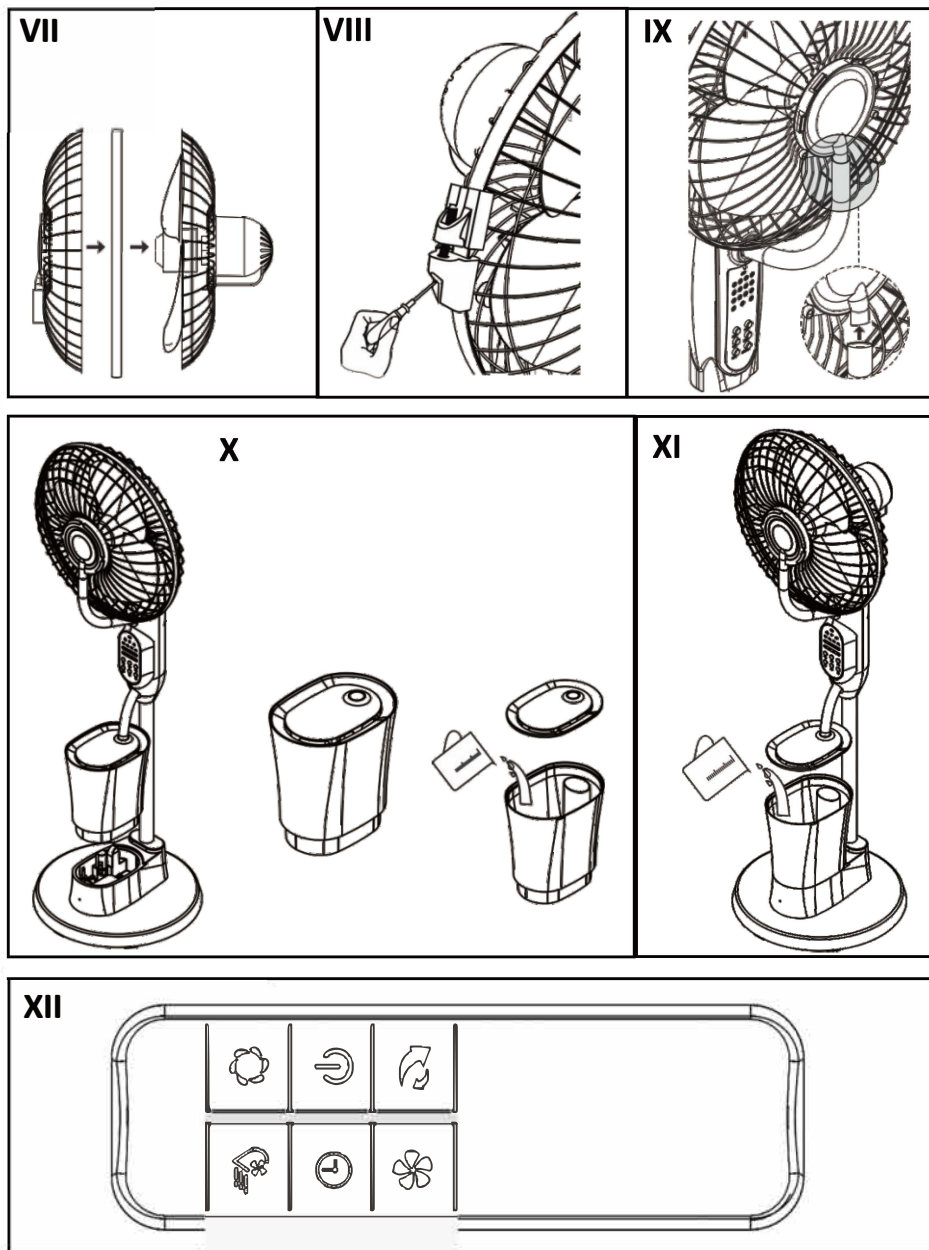
**A: MIST BUTTON**

1. Press the "Mist" button to switch the ultrasonic mist on or off. Adjust the mist volume (Max-Medium-Minimum) by pressing the "Mist" button several times.
2. When the mist function is selected, the water tank indicator light will be illuminated green.
3. If the water tank is empty (or short of water), the water indicator light will be illuminated red.
4. The mist function and fan function can be worked independently or together.

**B: TIMER BUTTON**

Press the "Timer" button when the fan is on. The indicator will show the time remaining until the fan is due to switch off. You can select the length of time the fan will be in operation from spans ranging from 0.5 to 7.5 hours in 0.5-hour increments. Press the TIMER button repeatedly, and the sum of the values of the lights is the remaining time until shut down.

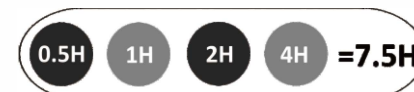
**C: WIND SPEED BUTTON**

1. Press the Power "ON/OFF" button to switch the fan ON.
2. Set the fan speed from three options (Low-Medium-High) by pressing the "WIND SPEED" button several times. The LED light will show low speed, Medium speed and high speed Correspondingly.

**D: MODE BUTTON**

1. The wind mode can be adjusted by pressing the "MODE" button.
2. Normal: The fan will operate in High, Medium or Low mode as set.
3. Natural: The fan will operate at low, medium and high speeds in different patterns to provide a wind flow that replicated natural airflow.
4. Sleep: Sleep mode can operate at low, medium and high speeds. In sleep mode, the wind speed will decrease in set patterns before operating at a low speed until shut down.

**E: ON/OFF BUTTON**

1. Press the "ON/OFF" button to switch the fan on or off.
2. Every 72 hours, the control panel lights flash to indicate that the water tank needs to be cleaned. Press the "ON/OFF" button 5 seconds to reset



- See P.2, Image VI, Install the rear grid, plastic nut, blades, and blade spinner to the motor shaft and fix in place.
- See P.3, Image VII, VIII and IX, Install the front grid and net frame, and secure using the screw on the net frame. Inset the upper flexible hose into the mist vent that is located at the front of the fan grid (ensure the hose is free of kinks).

### WATER TANK ASSEMBLY

- See P.2, Image IV, Put the water tank on the mist generator, ensuring it is appropriately seated in the recess.
- Fit the cover to the top of the water tank.
- Insert the lower flexible hose of the fan body into the water tank cover (ensure the hose is free of kinks)

### FILLING THE WATER TANK

- See P.3, Image X or XI, take off the cover of the water tank.
- Fill the tank with cold and clean water, making sure not to overfill it.
- See P.2, Image IV, put the cover on the tank and place the tank back on the mist generator.

### ATTENTION!

- Ensure the product is unplugged from the mains before filling or refilling the water tank.
- Only use water in the water tank. Do not add any chemicals, oils, or other additives.
- The water must not be warmer than 50°C.

### OPERATION ON THE FAN

When connected to the power supply, the fan is under standby mode. You can control the fan with the control buttons or remote.

#### OPERATION INSTRUCTIONS

See P.4, Image XIII.

#### 1. Remote control signal receiving

##### Indicator Lights:

- |                        |                          |                  |
|------------------------|--------------------------|------------------|
| 2. Mode Normal         | 3. Mode Sleep            | 4. Mode Natural  |
| 5. Timer 0.5H/1H/2H/4H | 6. Speed Low-Medium-High | 7. OSC           |
| 8. Mist Max            | 9. Mist Medium           | 10. Mist Minimum |

##### Control Buttons:

- |         |          |               |         |           |        |
|---------|----------|---------------|---------|-----------|--------|
| A. Mist | B. Timer | C. Wind Speed | D. Mode | E. ON/OFF | F. OSC |
|---------|----------|---------------|---------|-----------|--------|

See P.4, Image XIII.

### XIII

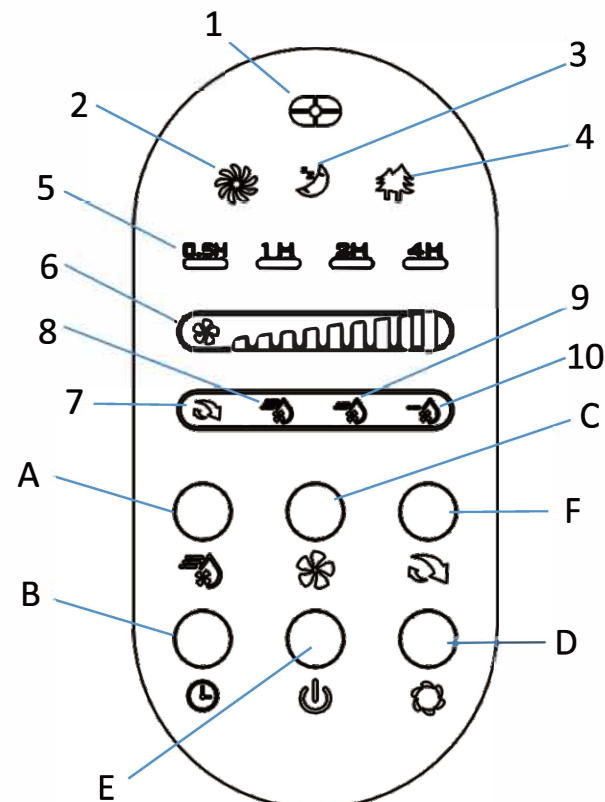

### XIV

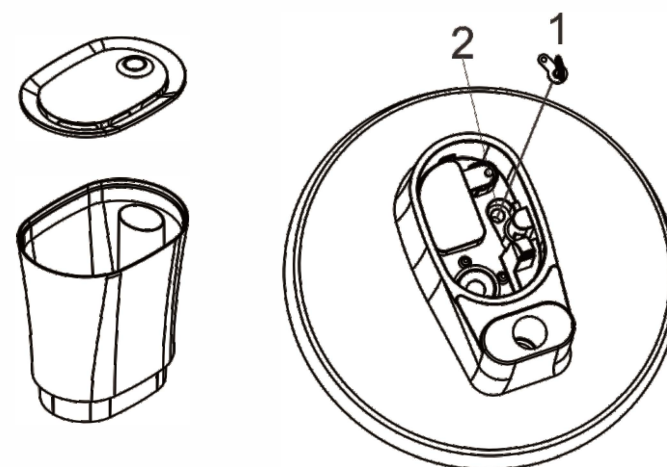

## GENERAL SAFETY WARNING:

1. Read carefully all instructions before using.
2. When using electrical appliances basic safety precautions should always be followed.
3. Connect to a main power supplier of 220-240V~ 50-60Hz only.
4. This appliance is intended for domestic use only.
5. Indoor use only.
6. Only operate the product when it is fully assembled.
7. Do not operate the product if it is dropped, damaged or showing signs of product malfunction. Do not operate the product with a damaged plug or cord.
8. This appliance is not intended for use by persons (including children) with reduced physical, sensory or mental capabilities, or lack of experience and knowledge, unless they have been given supervision or instruction concerning use of the appliance by a person responsible for their safety
9. Children should be supervised to ensure that they do not play with the appliance.
10. Cleaning and maintenance shall not be made by children without supervision.
11. Do not operate this fan with a damaged plug or cord, after a malfunction or after being dropped or damaged in any way.
12. If the supply cord is damaged, it must be replaced by the manufacturer, its service agent or similarly qualified persons in order to avoid a hazard.
13. Do not insert anything through the grid when the fan is in use.
14. Always operate on a stable flat horizontal surface.
15. The fan should be away from any heat source and corrosive gas surroundings.
16. Don't use in conjunction with or directly next to an air freshener or similar product.
17. To protect against electrical shock, do not immerse the fan, plug or cord in water or any other liquid or spray with liquids.
18. Do not leave hair, tissue, tablecloths, clothes or curtains near all openings of the fan, they could be sucked into the fan and be taken within the internal moving parts that could cause injury or damage.
19. Ensure the appliance is switched OFF before connecting to the mains power supply.
20. Always ensure that hands are dry before operating or adjusting any switch on the product or touching the plug and mains supply connections.
21. Do not leave this appliance unattended when it's in use. Turn off and disconnect the appliance when you leave the room for an extended period.
22. Switch off the appliance and unplug from the mains socket when not in use, before filling, cleaning or other maintain.
23. Be aware that high humidity levels may encourage the growth of biological organisms in the environment.

24. Do not permit the area around the appliance to become damp or wet. If dampness occurs, turn the output of the humidifier down. If the humidifier output volume cannot be turned down, use the appliance intermittently. Do not allow absorbent materials, such as carpeting, curtains, drapes, or tablecloths, to become damp.
25. Unplug the appliance during filling and cleaning.
26. Never leave water in the reservoir when the appliance is not in use.
27. Empty and clean the humidifier before storage, clean the humidifier before next use.
28. Micro-organisms that may be present in the water or in the environment where the appliances is used or stored, can grow in the water reservoir and be blown in the air causing very serious health risks when the water is not renewed. To prevent nucleation, remove residual water from the equipment and water tank every time after three days of use.
29. Empty the tank and refill it every 72 hours, before refilling, clean it with fresh tap water or cleaning agents if required by the manufacturer. Remove and scale, deposits, or film that has formed on the sides of the tank or on interior surfaces. And wipe all surfaces dry.
30. **Warning! Never use without the guards in place. After assembly, do not remove the guards during use or cleaning.**

## GETTING STARTED

Before using the mist fan for the first time:

- Carefully unpack the misting fan and remove all the packing materials.
- See P.1, Image I, Please check whether there are any missing parts, and the mist fan can be assembled only when the parts are complete.
- Use a soft cloth to remove any dust on the surface that may happen during packing and transport.
- Place the mist fan on a flat and stable surface.

## ASSEMBLY INSTRUCTIONS

1. See P.1, Image II, unscrew the screw of the short iron pipe, and then pass the wire through the long iron pipe. Then put the long iron pipe on the short iron pipe. Align the screw hole of the iron pipe on the base, fix it with the unscrewed screws.
2. See P.1, Image III, Install the weight plate on the base first, and fasten it with the M5x25 screws. Cover the metal rod of the 5 wheels with the 5 black plastic sleeves and insert them in the holes under the base.
3. See P.2, Image V, Loosen the fixing screw of the fan body, and then plug the fan body terminal and the terminal wire in the iron pipe. Tighten the screw.