

MAXIM[®]

kitchenpro

USER MANUAL

Hand Mixer

Model Number: MHM250



READ AND SAVE THESE INSTRUCTIONS

IMPORTANT SAFEGUARDS

When using any electrically powered product, basic safety precautions should always be followed, including the following:

PLEASE READ ALL INSTRUCTIONS CAREFULLY BEFORE USING THIS PRODUCT

WARNING! - to reduce the risk of fire, electrical shock or injury to persons or property:

- Carefully read all instructions before operation and save them for future reference.
- Remove and safely discard any packaging material before using the appliance for the first time.
- To eliminate a choking hazard for young children, remove and discard the protective cover that is fitted to the power plug of the appliance.
- Always operate the product from a power source of the same voltage, frequency and rating as indicated on the product identification plate.
- Do not allow children to use it as a toy.
- This appliance is not intended for use by persons (including children) with reduced physical, sensory or mental capabilities, or lack of experience or knowledge, unless they have been given supervision or instruction concerning use of the appliance by a person responsible for their safety.
- This appliance shall not be used by children. Keep the appliance and its cord out of reach away from children. Children shall not play with the appliance.
- Always disconnect the appliance from the supply if it is left unattended or not in use, and before assembling, disassembling or cleaning.
- Do not operate this product with a damaged cord or plug, or after the product malfunctions, or appears damaged in any way. Return appliance to the nearest authorized service center for examination, repair, adjustment or any other servicing.
- Do not continuously operate the mixer too long. The motor may overheat. For 1-5 Speed, continuously operate time must be less than 3 minutes.
- Do not use the beaters to mix too hard/solid ingredients.
- This appliance is designed for domestic household use only. No responsibility is accepted for damage resulting from use non-compatible with the instructions.
- Do not operate the hand mixer with wet hands.
- Avoid contacting moving parts.
- Do not let the cord hang over the edge of table or counter, or touch hot surfaces.
- The use of other accessory attachments not recommended by the appliance manufacturer may cause hazard or injury. Do not use any accessories other than the ones provided with this product.
- Always pull the plug out from the wall, never pull the cord. Remove the plug from the wall before moving the appliance. Use both hands to move the appliance.
- DO NOT place the appliance on, or near a hot gas or electric burner, or in a heated unit.
- Unplug from the power outlet when not in use and before cleaning. Allow to cool completely before putting on or removing parts, and before cleaning.
- Do not use outdoors. Indoor use only.
- Do not use the appliance other than for its intended purpose.
- For general hygiene purposes, all components should be thoroughly cleaned before first use.
- To protect against electric shock, do not immerse the power cord, plug or body of the mixer into water or any other liquid.
- There are no user serviceable parts. If the supply cord is damaged, it must be replaced by the manufacturer or its authorized service agent, or a similarly qualified person in order to avoid a hazard.
- Never eject the beaters or dough hooks when the appliance is in operation.
- Before connecting to the power outlet and switching on, make sure that the beaters/dough hooks have been correctly installed.
- Remove beaters/dough hooks from the hand mixer before cleaning.

- After switching off the mixer, always wait until the motor has come to a complete stop before handling the attachments.
- To reduce the risk of injury to persons, and/or damage to the mixer, keep hands, hair, clothing, spatulas and other utensils away from the beaters during operation.
- Switch off the appliance and disconnect from the power outlet before changing accessories or touching parts that move when in use.
- When assembling the beaters, make sure the beaters do not touch each other or rub against each other. If this happens, interchange the beaters on the unit.

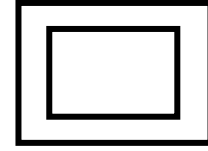

READ AND SAVE THESE INSTRUCTIONS FOR FUTURE REFERENCES

BEFORE FIRST USE

Read and follow the instructions in this user manual even if you feel you are familiar with the product, and find a place to keep it handy for future reference.

For your convenience record the complete model number (located on the product identification plate) and the date you received the product, together with your purchase receipt and attach to the warranty and service information. Retain in the event that warranty service is required.

NOTE: The rating of this product (as marked on the product identification plate) is based on specific loading tests. Normal use or the use of other recommended attachments may draw significantly less power.

PARTS & FEATURES

1. Turbo Control
2. Speed Control
3. Ejector Knob
4. Main Housing
5. Beaters
6. Hooks
7. Stainless Steel Shell
8. Cord

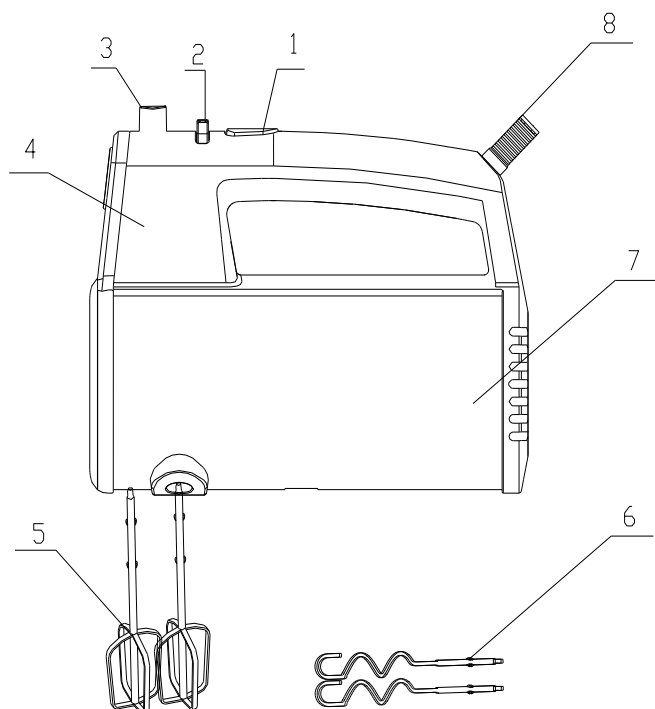

USING YOUR HAND MIXER

NOTE:

Remove any packaging, disassemble any detachable parts and clean the dough hooks and beaters. Before assembling the mixer, ensure that the power cord is unplugged from the power outlet and the speed selector is on the "0" position.

Unplug the appliance from the power outlet before attaching or removing the beaters or dough hooks.

1. Fit the Beaters (5) or Hooks (6) to the Beaters Holes.
2. Plug in the appliance.
3. Hold the mixer handle. Lower the beaters or hooks into ingredients.
4. Switch on the Speed Control (1) and select the desired speed. The mixer will begin to mix the ingredients in the bowl.
5. When you have finished mixing, stop the mixer by pushing the speed button to "0" immediately.
6. Wait until the beaters/hooks have stopped revolving; press the Ejector knob (3) to remove the beaters/hook. Switch off the appliance before changing accessories or approaching which move in use.
7. You can press the "Turbo" Knob (1) to accelerate the speed during mixing.
8. Unplug the appliance when you have finished mixing. Clean the beaters/hooks with water. Dry the accessories before storing in the box together with the main body.

MIXING GUIDE

SPEED	DESCRIPTION
1 FOLD	This is a good starting speed for bulk and dry foods such as flour and butter.
2 BLEND	Best speed to start liquid ingredients for mixing salad dressings.
3 MIX	For mixing cake, cookies and quick breads.
4 CREAM	For creaming butter and sugar. Beating uncooked candy, desserts. etc.
5 WHIP	For beating eggs, cooked icings and whipping cream, etc.

NOTE: Use hooks if mixing thick and sticky flour. Use beaters if beating eggs.

CARE & CLEANING

WARNING:

- **BE SURE TO ALWAYS UNPLUG THE APPLIANCE BEFORE ASSEMBLING, DISASSEMBLING OR CLEANING.**
- **DO NOT IMMERSE THE POWER CORD, PLUG OR BODY OF THE MIXER INTO WATER OR ANY OTHER LIQUID.**

- Unplug the appliance from the power outlet and wait for it to completely cool down before cleaning.
- Wipe over the outside surface of the hand mixer with a damp cloth, and dry with a soft dry cloth.
- Wipe any excess food particles from the power cord with a damp cloth.
- Wash the beaters and dough hooks in warm soapy water and wipe dry.
- Dry the accessories before storing in the box together with the main body.

SPECIFICATIONS

Model	Brand	Description	Voltage	Frequency	Wattage
MHM250	Maxim Kitchenpro	Hand Mixer 250W	220-240Vac	50/60Hz	250W

ENVIRONMENT FRIENDLY DISPOSAL



This marking indicates that this product should not be disposed of with other household waste. To prevent possible harm to the environment or human health from uncontrolled waste disposal, recycle it responsibly to promote the sustainable re-use of material resources. To dispose of your appliance correctly, please contact or take it to your local refuse/ recycling centre. Alternatively, contact your local council or information on your local re-use centre. Please make this product environmentally safe for recycling.

CUSTOMER SERVICE

Australian Customer Service

GAF Control (Sales) Pty Ltd

P.O Box 19

Altona North Victoria 3025

Phone: 1300 659 489

Hours: 9am-5pm (EST) Mon-Fri

www.gafcontrol.com.au

*This product may vary slightly to the product illustrated due to ongoing product development.

WARRANTY

Our goods come with guarantees that cannot be excluded under Australian Consumer Law. You are entitled to a replacement or refund for a major failure and compensation for any other foreseeable loss or damage. You are also entitled to have the goods repaired or replaced if the goods fail to be of acceptable quality and the failure does not amount to a major failure. The above applies subject to the item not being accidentally dropped by the user-or being used for purposes other than the intended use - or being tampered with. Maxim Housewares guarantees the product for 12 months from date of purchase. Refunds or replacements at retail store level are under the guidance of the stores rules/regulations. In the event of requiring assistance, the retailer from whom you purchased the product should be your first port of call.

Supplier warranting this product:

GAF Control (Sales) Pty Ltd

P.O. Box 19, Altona North

Victoria, 3025, Australia.

12 months warranty from date of purchase. 90 days warranty from date of purchase if used commercially. If your retailer has not validated your guarantee, then retain your purchase receipt. The guarantee does not cover accidental breakage or damage of your product or if it has been tampered with.

Product Model Number: MHM250

Purchase Date: _____

Retailer: _____

Retailer Store Address: _____

Name of Purchaser: _____

Address: _____

Due to the Maxim policy of continual product development; specifications, colours and details of our products may differ slightly from what is in, or depicted in this user manual or on the product and its carton.

Product: Made in China.

To view the full range of Maxim Housewares products, please go to our website.

www.gafcontrol.com.au

For additional consumer support – email us at:

gaf@gafcontrol.com.au