

MAXIM[®]

kitchenpro

TEPPANYAKI & BBQ GRILL 2000W

User Manual

Model Number: MTG200



READ AND SAVE THESE INSTRUCTIONS

IMPORTANT

Please read and follow the instructions in this user manual even if you feel you are familiar with the product, and find a place to keep it handy for future reference.

For your convenience, record the complete model number (located on the product identification plate) and the date you received the product together with your purchase receipt, and attach to the warranty and service information. Retain in the event that warranty service is required.

NOTE: The rating of this product (as marked on the product identification plate) is based on specific loading tests. Normal use or the use of other recommended attachments may draw significantly less power.

IMPORTANT SAFEGUARDS

When using any electrically powered product, basic safety precautions should always be followed, including the following:

PLEASE READ ALL INSTRUCTIONS CAREFULLY BEFORE USING THE PRODUCT.

WARNING - to reduce the risk of fire, electrical shock or injury to persons or property:

- Always operate the product from a power source of the same voltage, frequency and rating as indicated on the product identification plate.
- Close supervision is necessary when the product is used by or near children or invalids. Do not allow children to use it as a toy.
- Do not operate any product with a damaged cord or plug, or after the product malfunctions, or is dropped or appears damaged in any way. Return the complete product to the place of purchase for inspection, repair or replacement.
- This product should not be used in the immediate vicinity of water, such as bathtub, washbowls, basins or other vessels containing liquids where the likelihood of immersion or splashing could occur.
- Never place or operate the unit where any part of it could come into contact with any hot surface (such as a gas or electric hot plate or heated oven).
- Do not allow the cord to hang over the edge of a table or bench or touch hot surfaces. Allow unit to cool before wrapping cord around base for storage.
- Switch off and unplug from outlet when not in use, before assembling or disassembling parts and before cleaning. Remove by grasping the plug - do not pull on the cord.
- Do not use the appliance for other than its intended use.
- Do not leave the appliance unattended when switched on.
- Care must be taken not to touch any hot surfaces. Allow unit to cool before wrapping cord around base for storage.
- Do not place this appliance on or near a hot gas or electric burner, in or where it could touch a heated oven or a microwave oven.
- Do not use this appliance outdoors.
- Do not place objects on the product or allow objects to obstruct the inlet or outlet openings, or operate in close proximity to walls or curtains, etc.
- **CAUTION:** The housing gets hot when in operation. RISK OF BURNS!
- Do not place the appliance on a sensitive surface (e.g. painted furniture) and keep a distance of at least 70cm from combustible materials (e.g. curtains).
- The use of attachments or accessories not recommended or sold by the product distributor may cause personal or property hazards or injuries.
- This product is intended for normal domestic/household use only.
- This appliance is not intended for use by persons (including children) with reduced physical, sensory or mental capabilities, or lack of experience and knowledge, unless they have been given supervision or instruction concerning use of the appliance by a person responsible for their safety.
- Children should be supervised to ensure that they do not play with the appliance.

- The appliance is not intended to be operated by means of an external timer or separate remote-control system.
- If the supply cord is damaged, it must be replaced by the manufacturer, its service agent or similarly qualified persons in order to avoid a hazard.
- The appliance is not intended to be operated by means of an external timer or separate remote-control system.
- The appliance cannot be partially or fully immersed in water for cleaning.
- To protect against risk of electrical shock, do not immerse or rinse housing, cord or plug in water or other liquid.
- Switch off the appliance before changing accessories or approaching parts, which move in use.
- **CAUTION: DO NOT TOUCH HOT SURFACES. USE HANDLES.**
- An insulated hot pad protection is recommended when using this grill on surfaces which heat may cause damage.
- The temperature of accessible surfaces may be high when the appliance is operating.
- Only the appropriate power control and heat control probe supplied by the manufacturer must be used.
- The power plug probe must be removed before the appliance is cleaned and that the appliance power inlet must be dried before the appliance is used again.
- Do not use metal spatulas as they may damage the cooking surface.
- Never put the appliance on a hob.
- When the appliance is switched on the light will illuminate and extinguish as the thermostat switches the heating element on and off to maintain the required temperature.
- A little hot fat can splash from the appliance when the thermostat is set to higher than 165 degrees Celsius.
- Do not touch the hot grill plate. Use oven gloves if you need to touch the appliance during or shortly after use.

FEATURES

- Cool touch easy grip handles
- Grill
- Knob of thermostat control
- Indicator light
- Removable thermostat control
- Thermostat control socket

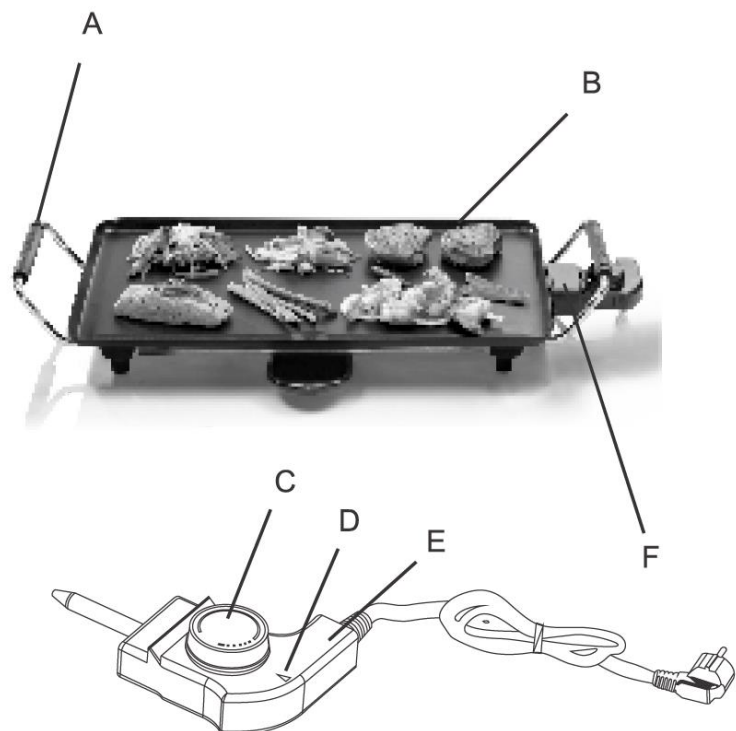

INSTRUCTIONS

1. Plug into an earthed power socket.
2. Place the appliance on a flat, stable and heat-resistant surface; keep inflammable items away from the appliance.
3. Smear a little of butter or cooking oil on the grill plate. This makes it easier to turn the food over.
4. Plug the thermostat probe into the thermostat socket.
5. Adjust the thermostat dial to your desired setting, the temperature light illuminates.
6. Wait for several minutes until the temperature light has extinguished. The grill plate has now reached the required temperature. It is ready for use.
7. Use the spatula to turn the food over during frying and grilling.
- 8.

GRILL COOKING CHART: This cooking chart is for guidance reference only.

Control No.	1	2	3	4	5
Temperature	110	130	160	180	210

FOOD, TEMPERATURE APPROX SUGGESTED COOKING TIME – FOR GUIDANCE/ REFERENCE ONLY!

Beef Steaks – ½” Thick	210°C	10-15 Minutes
Chicken Breasts	210°C	20-30 Minutes
Pork Chops	160°C	15-20 Minutes
Hamburgers	180°C	10-15 Minutes
Hot Dogs	160°C	10-15 Minutes
Sausages	180°C	5-10 Minutes
Fish Filets	160°C	10-15 Minutes
Bacon	160°C	10-12 Minutes
Vegetables	160°C	10-15 Minutes
Pancakes	160°C	5-10 Minutes

CLEANING AND STORING

1. Disconnect the plug from wall power outlet and then remove the power cord connector probe together with power cord from the appliance.
2. Allow the unit to completely cool down before cleaning or storing.
3. Wipe off the grill pan with warm soapy water using a sponge or dish cloth.
4. Wipe off thoroughly to remove soap residue.
5. Always unplug the grill and allow it to cool before starting to clean.
6. Do not use abrasive cleaners or scouring pads.
7. Do not put temperature control or power cord in the dishwasher.
8. Never immerse the cord, plug or temperature selector probe in any liquids.
9. Do not soak the grill in water.
10. The connector probe must be removed before the appliance is cleaned and that the appliance power inlet must be dried before the appliance is used again.
11. When not in use, remove the power plug from the mains electrical supply and store the toaster in a dry, safe place, out of reach of children

NOTE: NEVER IMMERSE UNIT IN WATER OR ANY OTHER LIQUID.

ENVIRONMENT FRIENDLY DISPOSAL



This marking indicates that this product should not be disposed of with other household waste. To prevent possible harm to the environment or human health from uncontrolled waste disposal, recycle it responsibly to promote the sustainable re-use of material resources. To dispose of your appliance correctly, please contact or take it to your local refuse/ recycling centre. Alternatively, contact your local council or information on your local re-use centre. Please make this product environmentally safe for recycling.

SPECIFICATIONS

Model	Description	Voltage	Frequency	Wattage
MTG200	TEPPANYAKI & BBQ GRILL	220-240V~	50Hz	2000W

CUSTOMER SERVICE

Australian Customer Service

GAF Control (Sales) Pty Ltd

P.O Box 19

Altona North Victoria 3025

Phone: 1300 659 489

Hours: 9am-5pm (EST) Mon-Fri

www.gafcontrol.com.au

*This product may vary slightly to the product illustrated due to ongoing product development.

WARRANTY

Our goods come with guarantees that cannot be excluded under Australian Consumer Law. You are entitled to a replacement or refund for a major failure and compensation for any other foreseeable loss or damage. You are also entitled to have the goods repaired or replaced if the goods fail to be of acceptable quality and the failure does not amount to a major failure. The above applies subject to the item not being accidentally dropped by the user-or being used for purposes other than the intended use - or being tampered with. Maxim Housewares guarantees the product for 12 months from date of purchase. Refunds or replacements at retail store level are under the guidance of the stores rules/regulations. In the event of requiring assistance, the retailer from whom you purchased the product should be your first port of call.

Supplier warranting this product:

GAF Control (Sales) Pty Ltd

P.O. Box 19, Altona North

Victoria, 3025, Australia.

12 months warranty from date of purchase. 90 days warranty from date of purchase if used commercially. If your retailer has not validated your guarantee, then retain your purchase receipt. The guarantee does not cover accidental breakage or damage of your product or if it has been tampered with.

Product Model Number: MTG200

Purchase Date: _____

Retailer: _____

Retailer Store Address: _____

Name of Purchaser: _____

Address: _____

Due to the Maxim policy of continual product development; specifications, colours and details of our products may differ slightly from what is in, or depicted in this user manual or on the product and its carton.

Product: Made in China.

To view the full range of Maxim Housewares products, please go to our website.

www.gafcontrol.com.au

For additional consumer support – email us at:

gaf@gafcontrol.com.au