

MAXIM®

Instruction Manual

ELECTRIC WOK

Model: MW45



READ AND SAVE THESE INSTRUCTIONS

Please read and follow the instructions in this user manual even if you feel you are familiar with the product, and find a place to keep it handy for future reference.

For your convenience record the complete model number (located on the product identification plate) and the date you received the product, together with your purchase receipt and attach to the warranty and service information. Retain if warranty service is required.

NOTE: The rating of this product (as marked on the product identification plate) is based on specific loading tests. Normal use or the use of other recommended attachments may draw significantly less power.

For your own safety read these instructions carefully before using the appliances.

ELECTRIC PARAMETER AND MODEL

Model: MW45

Rated Voltage: 220-240V~

Rated Frequency: 50-60Hz

Rated Power: 1500W

Location of Parts and Control

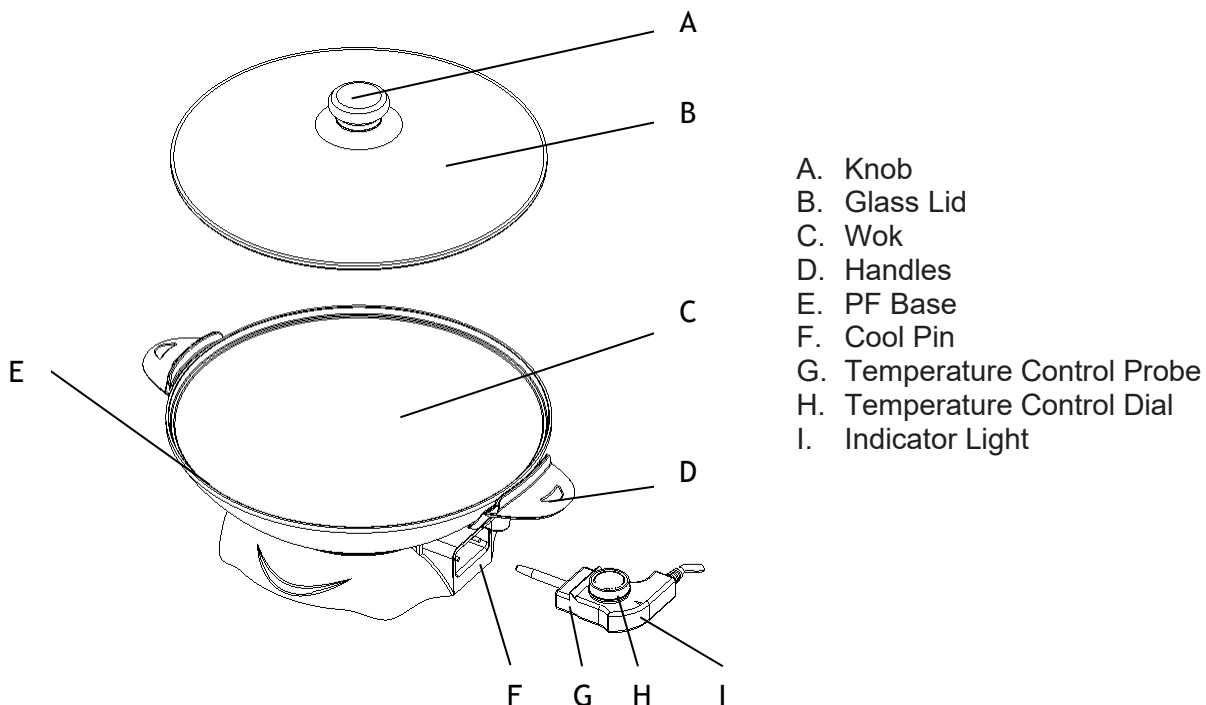

IMPORTANT SAFEGUARDS

When using electrical appliances, basic safety precautions should always be

1. followed, including the following:
 1. Read all instructions carefully.
 2. This appliance may only be connected to the same main voltage as shown on the rating plate.
 3. To protect against risk of electrical shock, do not immerse or rinse housing, cord or plug in water or other liquid.
 4. Close supervision is necessary when any appliance is used near children.
 5. Unplug from outlet when not in use, before putting on or taking off parts and before cleaning.
 6. Do not contact any moving parts while the appliance is operating.
 7. If the supply cord is damaged, it must be replaced by the manufacturer or its authorized service agent or a similarly qualified person to avoid hazard & damage to the unit.
 8. The use of attachment or accessories which are not supplied with the appliance are not recommended. Only the connector provided with the appliance must be used with the appliance. Otherwise, it could result in electrical shock or injury or permanent damage to the appliance.
 9. Do not let cord hang over edge of table or counter or touch hot surface.
 10. Do not use the appliance for other than intended household use.
 11. Switch off the appliance before changing accessories or approaching parts, which move in use.
 12. This appliance is for household use and may be plugged into any AC electrical outlet (ordinary household current). Do not use any other electrical outlet.
 13. Do not touch hot surfaces. Use handles.
 14. An insulated hot pad protection is recommended when using this frying pan on surfaces which heat may cause damage.
2. 15. The temperature of accessible surfaces may be high when the appliance is operating.
3. 16. The appliance is not intended to be operated by means of an external timer or separate remote-control system.
4. 17. The appliance cannot be partially or fully immersed in water for cleaning.
5. 18. Only the appropriate connector supplied by the manufacturer must be used.
6. 19. The appliance can only be used for household indoor only.
7. 20. Connector must be removed before the appliance is cleaned and that the appliance inlet must be dried before the appliance is used again.
8. 21. Only the appropriate connector must be used.
9. This appliance is not intended for use by persons (including children) with reduced physical, sensory or learning disabilities, or lack of experience and knowledge, unless they have been given supervision or instruction concerning use of the appliance by a person responsible for their safety.
10. Children should be supervised to ensure that they do not play with the appliance.
11. The appliance can be used by children aged from 8 years and above and persons with reduced physical, sensory or mental capabilities or lack of experience and knowledge if they have been given supervision or instruction concerning use of the appliance in a safe way and understand the hazards involved. Children shall not play with the appliance. Cleaning and user maintenance shall not be made by children unless they are older than 8 and supervised.
12. Keep the appliance and its cord out of reach of children less than 8 years.
13. The appliance should be positioned in a stable situation to avoid spillage of the hot liquids during cooking.

Before first use

- Before using the unit for the first time, carefully clean the unit and cover.
- Do not use any aggressive detergents, brushes with metal or nylon bristles or sharp objects such as knives or spatulas for cleaning the unit.
- Avoid damaging the non-stick coating.
- Always dry the unit thoroughly after cleaning it.

Assembling the glass lid

- Screw and assemble the plastic vented knob to the glass lid.

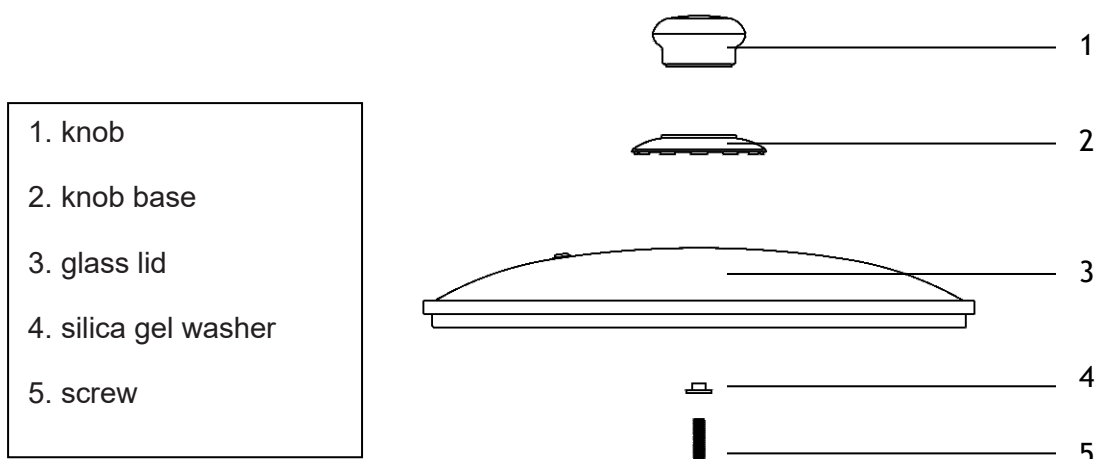

Connecting the unit

1. Connect the temperature regulator to the base of unit(220-240Vac). Make sure that the plug is connected properly.
2. Set the temperature regulator to heat level "0".
3. Connect the plug to a socket.



Preparing food

1. Brush the frying pan with a little cooking oil.
2. Set the temperature regulator to the required heat level. The control lamp will light up to show that the unit is ready for use (ON).

It takes approximately 5 -10 minutes to heat up the unit and the control lamp goes out. You can then start cooking the food.

If the food is completely done, you can adjust the temperature to lower or "0" heat level.

Using the cover

Use the glass cover where possible when cooking all food types. The cover prevents smells from escaping and reduces cooking time.

The lid knob of glass cover is designed with vents all the way round. It allows condensation from the steam and the water and prevents to build up the dirt and grease. It is necessary to unscrew and disassemble the lid knob for easy cleaning.

NOTE:

- The glass cover has a vent through which hot steam can escape!
- Avoid contact with this escaping steam.
- The cover can become extremely hot during operation therefore use oven gloves, etc. where possible when removing the cover to avoid burns.

CLEANING INSTRUCTIONS

1. Disconnect the plug from wall outlet, and then remove the power cord connector together with power cord from the appliance.
2. Allows the unit to completely cool.
3. Wipe off the frying pan with warm soapy water using a sponge or dishcloth.
4. wipe off thoroughly to remove soap residue.
5. Always unplug the frying pan and allow it to cool before starting to clean.
6. Do not use abrasive cleaners or scouring pads.
7. Do not put temperature control or power cord in the dishwasher.
8. Never immerse the cord, plug or temperature selector in any liquid.
9. Do not soak the frying pan in water.
10. The connector must be removed before the appliance is cleaned and that the appliance inlet must be dried before the appliance is used again.

Instructions on environment protection



Do not dispose of this product in the usual household garbage at the end of its life cycle; hand it over at a collection point for the recycling of electrical and electronic appliances. The symbol on the product, the instructions for use or the packing will inform about the methods for disposal.

The materials are recyclable as mentioned in its marking. By recycling, material recycling or other forms of re-utilization of old appliances, you are making an important contribution to protect our environment.

Please inquire at the community administration for the authorized disposal location.

CUSTOMER SERVICE

Australian Customer Service

GAF Control (Sales) Pty Ltd

P.O Box 19

Altona North Victoria 3025

Phone: 1300 659 489

Hours: 9am-5pm (EST) Mon-Fri

www.gafcontrol.com.au

*This product may vary slightly to the product illustrated due to ongoing product development.